

434x250cm

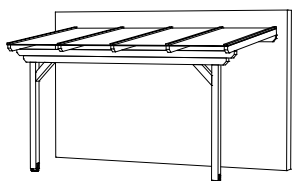

4018211 201259

541x250cm

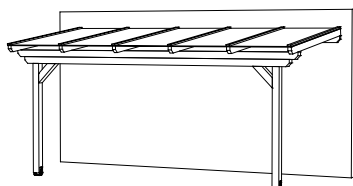

4018211 201334

648x250cm

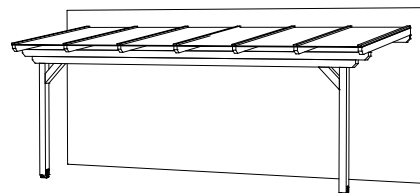

4018211 201419

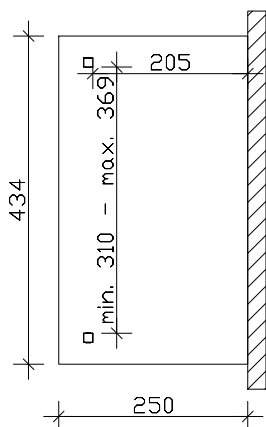

Floor plan

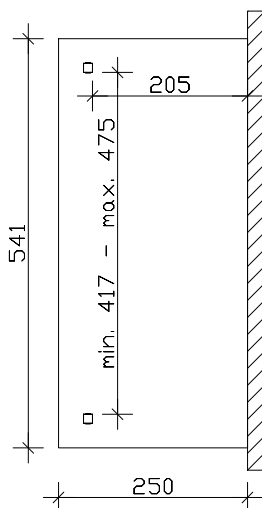

Floor plan

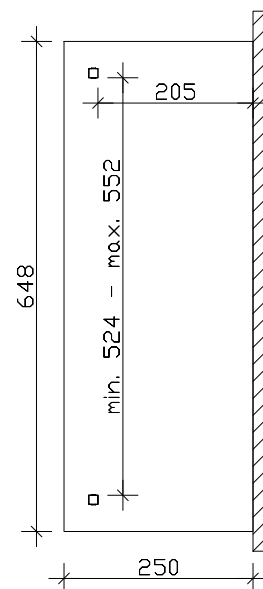

Floor plan

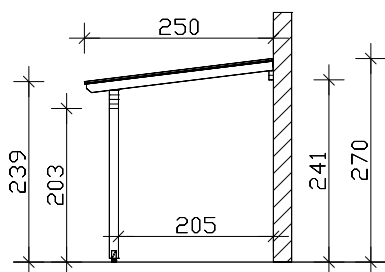

Side View

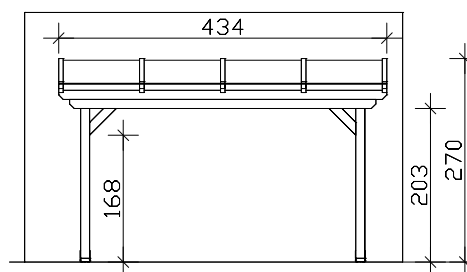

Front View

M 1:100

## "Ancona" Terrace roof 434cm / 541cm / 648cm x 250cm

### Datensheet / Construction Description

Type of wood / Hardware	glulam, untreated / galvanised
Posts	2 pieces 12x12x198cm
Roof covering	double bar 16mm (transparent)
Snow load	sk = 2,00kN/m <sup>2</sup>
Length x Depth	434cm / 541cm / 648cm x 250cm (roofed area)
Height / Entrance	239-270cm / 203cm (incl. distance to the ground, Screw on post = 5cm)
Area (building volume)	10,85m <sup>2</sup> (27,61m <sup>3</sup> ) / 13,53m <sup>2</sup> (34,43m <sup>3</sup> ) / 16,20m <sup>2</sup> (41,23m <sup>3</sup> )
Roof inclination	7°
Package dimensions	W x L x H 120x435-650x45-48cm / weight 225/265/305kg
Including	Mounting material, Screw on post, Upper struts, set up instructions (without wall mounting, without wall finishing profile)

# Ancona Terrace roof



434x300cm

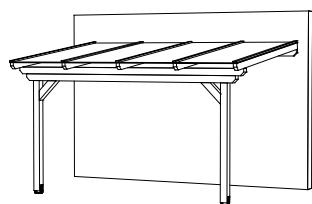

4018211 201273

541x300cm

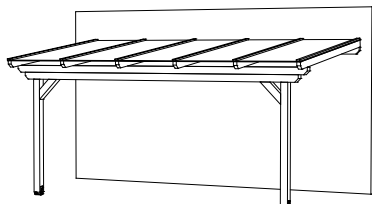

4018211 201358

648x300cm

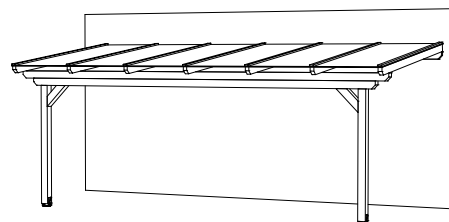

4018211 201433

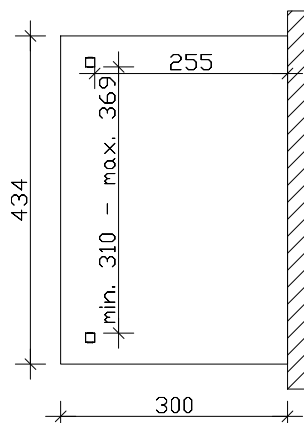

Floor plan

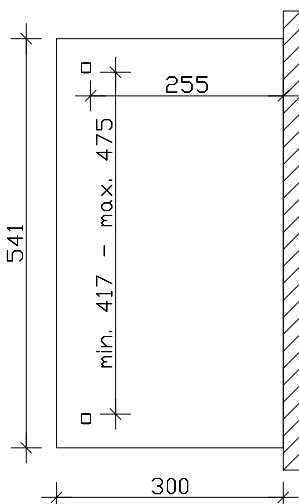

Floor plan

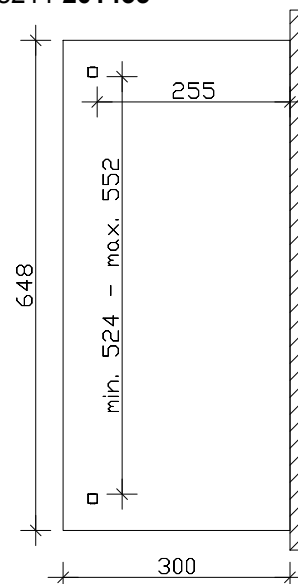

Floor plan

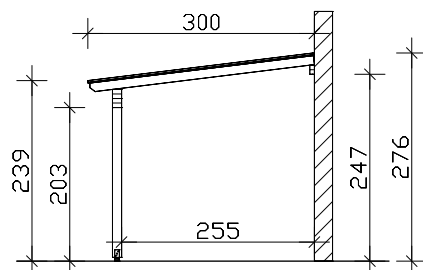

Side View

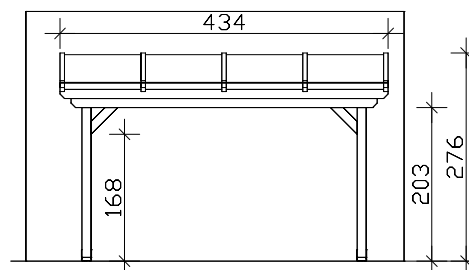

Front View

M 1:100

## "Ancona" Terrace roof 434cm / 541cm / 648cm x 300cm

### Datensheet / Construction Description

Type of wood / Hardware	glulam, untreated / galvanised
Posts	2 pieces 12x12x198cm
Roof covering	double bar 16mm (transparent)
Snow load	sk = 1,65kN/m <sup>2</sup>
Length x Depth	434cm / 541cm / 648cm x 300cm (roofed area)
Height / Entrance	239-276cm / 203cm (incl. distance to the ground, Screw on post = 5cm)
Area (building volume)	13,02m <sup>2</sup> (33,53m <sup>3</sup> ) / 16,23m <sup>2</sup> (41,79m <sup>3</sup> ) / 19,44m <sup>2</sup> (50,06m <sup>3</sup> )
Roof inclination	7°
Package dimensions	W x L x H 120x435-650x45-48cm / weight 240/285/330kg
Including	Mounting material, Screw on post, Upper struts, set up instructions (without wall mounting, without wall finishing profile)

# Ancona Terrace roof



434x350cm

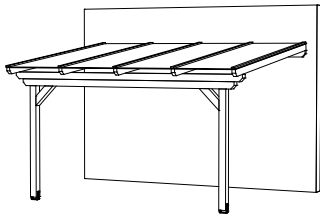

4018211 201297

541x350cm

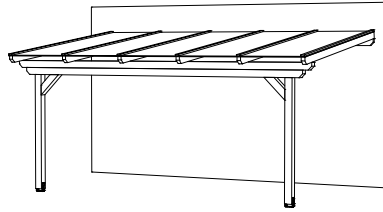

4018211 201372

648x350cm

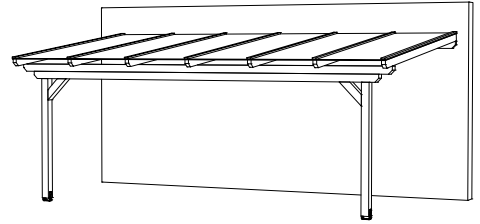

4018211 201457

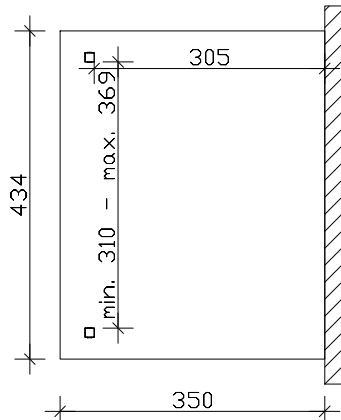

Floor plan

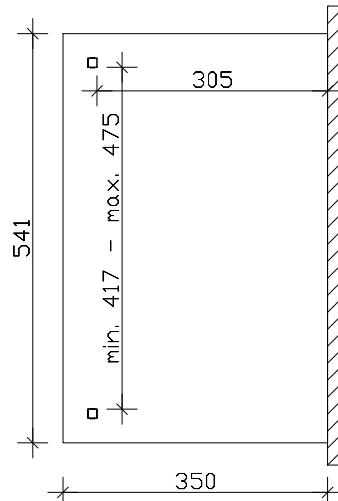

Floor plan

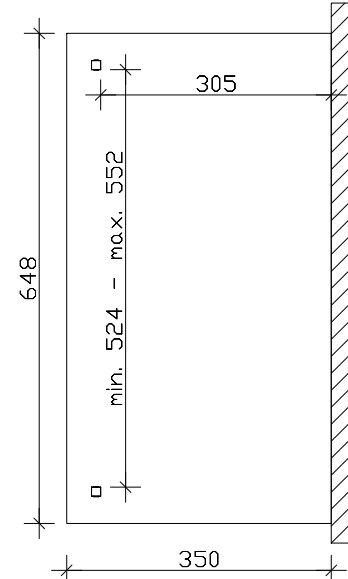

Floor plan

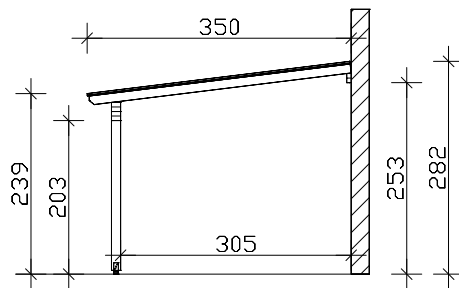

Side View

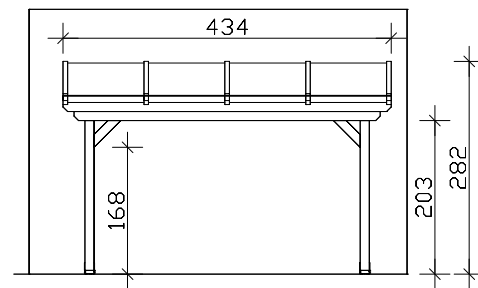

Front View

M 1:100

## "Ancona" Terrace roof 434cm / 541cm / 648cm x 350cm

### Datensheet / Construction Description

Type of wood / Hardware	glulam, untreated / galvanised
Posts	2 pieces 12x12x198cm
Roof covering	double bar 16mm (transparent)
Snow load	sk = 1,00kN/m <sup>2</sup>
Length x Depth	434cm / 541cm / 648cm x 350cm (roofed area)
Height / Entrance	239-282cm / 203cm (incl. distance to the ground, Screw on post = 5cm)
Area (building volume)	15,19m <sup>2</sup> (39,57m <sup>3</sup> ) / 18,94m <sup>2</sup> (49,34m <sup>3</sup> ) / 22,68m <sup>2</sup> (59,08m <sup>3</sup> )
Roof inclination	7°
Package dimensions	W x L x H 120x435-650x45-48cm / weight 255/302,5/350kg
Including	Mounting material, Screw on post, Upper struts, set up instructions (without wall mounting, without wall finishing profile)

# Ancona Terrace roof



434x400cm

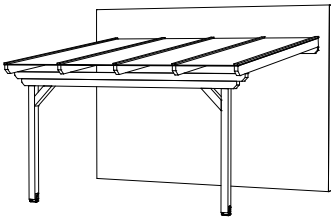

4018211 201310

541x400cm

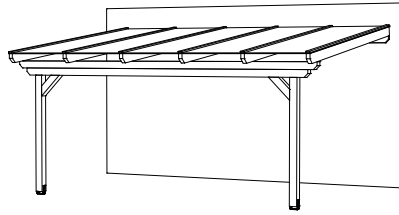

4018211 201396

648x400cm

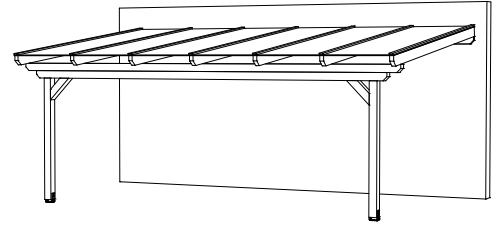

4018211 201471

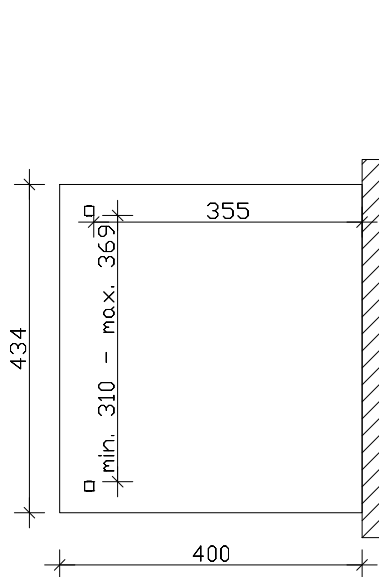

Floor plan

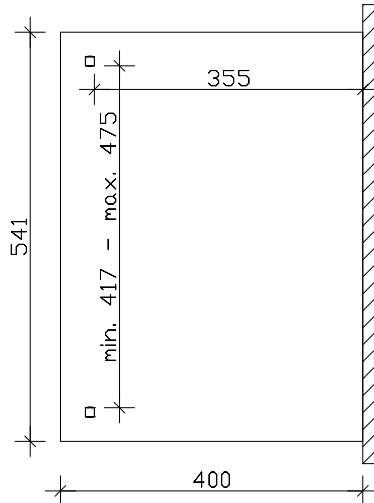

Floor plan

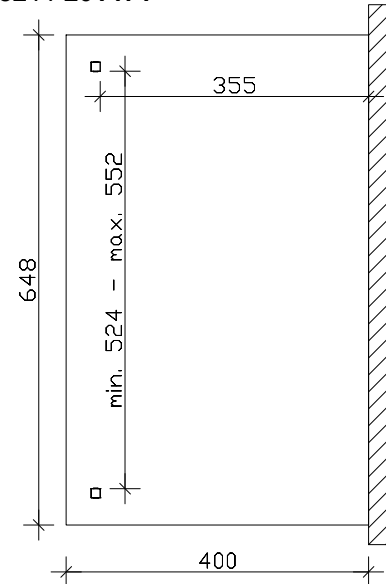

Floor plan

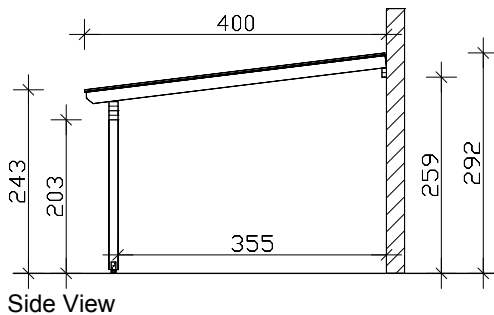

Side View

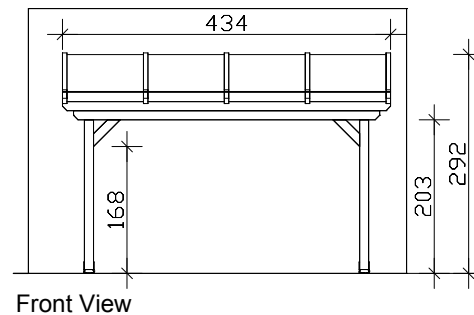

Front View

M 1:100

## "Ancona" Terrace roof 434cm / 541cm / 648cm x 400cm

### Datensheet / Construction Description

Type of wood / Hardware	glulam, untreated / galvanised
Posts	2 pieces 12x12x198cm
Roof covering	double bar 16mm (transparent)
Snow load	sk = 1,45kN/m <sup>2</sup>
Length x Depth	434cm / 541cm / 648cm x 400cm (roofed area)
Height / Entrance	243-292cm / 203cm (incl. distance to the ground, Screw on post = 5cm)
Area (building volume)	17,36m <sup>2</sup> (46,43m <sup>3</sup> ) / 21,64m <sup>2</sup> (57,89m <sup>3</sup> ) / 25,92m <sup>2</sup> (69,34m <sup>3</sup> )
Roof inclination	7°
Package dimensions	W x L x H 120x435-650x45-48cm / weight 305/362,5/420kg
Including	Mounting material, Screw on post, Upper struts, set up instructions (without wall mounting, without wall finishing profile)